

# FE-IPDS-27S INSTALLATION GUIDE

PERFECT INTERCOM CHOICE FOR DAILY LIFE

## INSTALLATION

### STEP 1: BRACKET/BOX INSTALLATION WALL MOUNTING

#### WITH 86 EMBEDDED BOX IN THE WALL

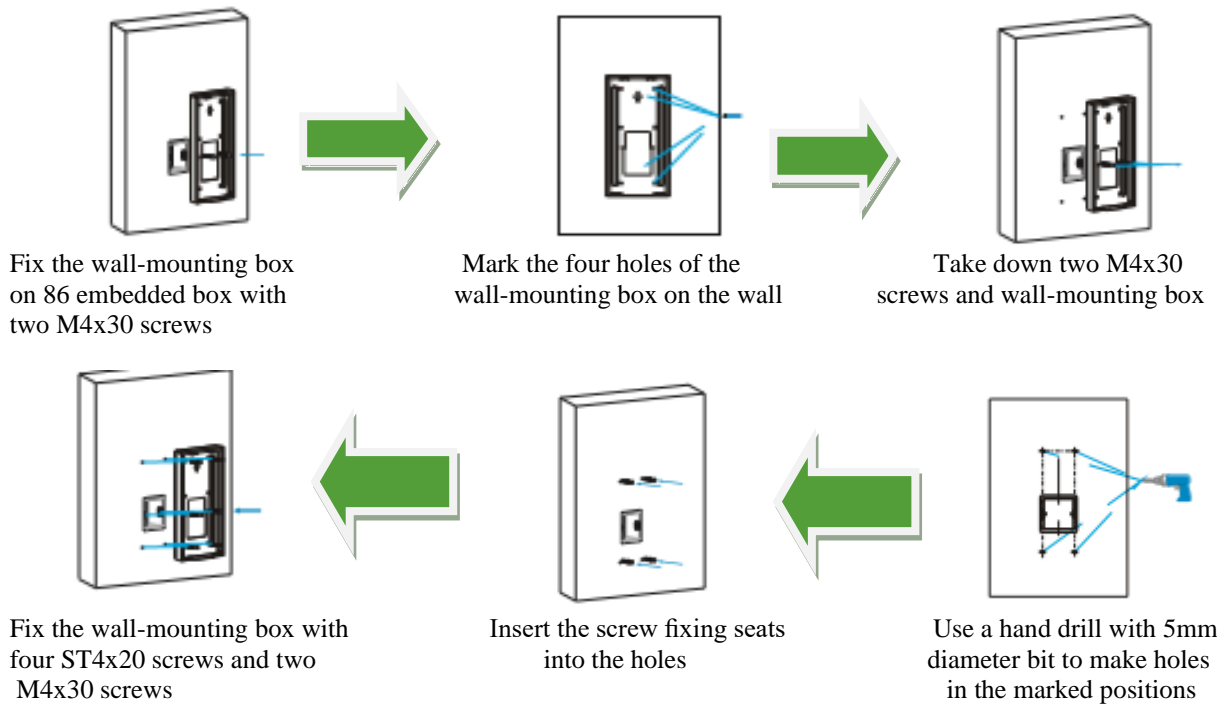

#### WITHOUT 86 EMBEDDED BOX IN THE WALL

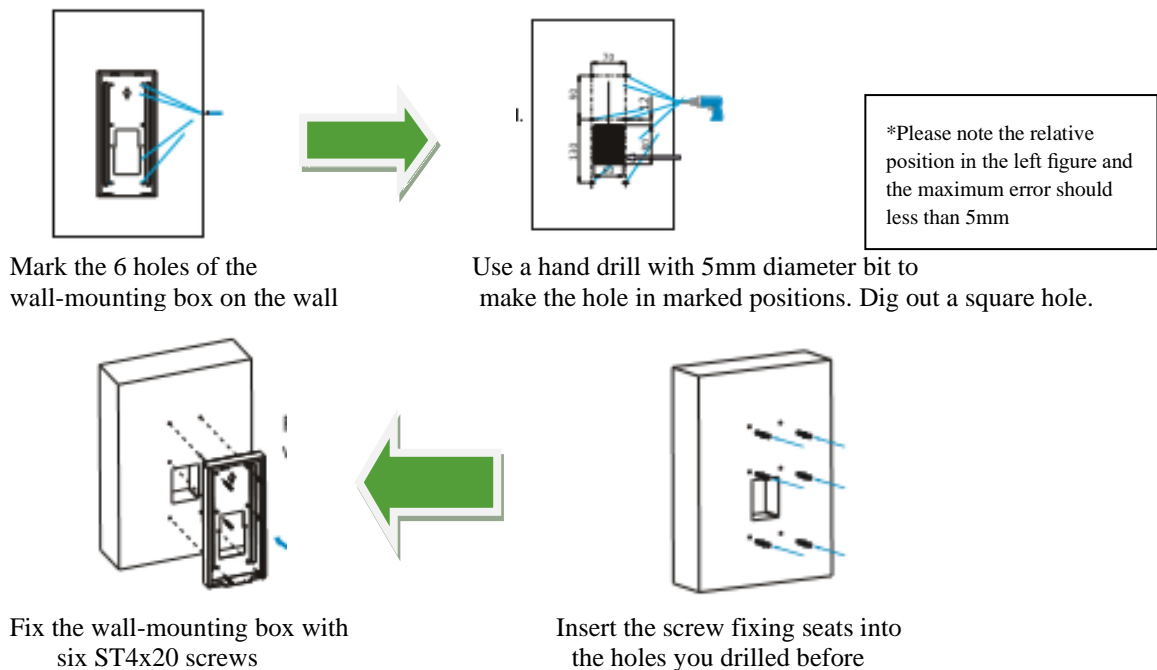

**FLASH MOUNTING**

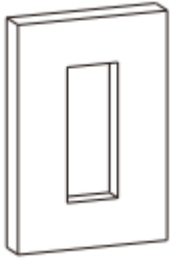

Dig out a square hole (height\* width\*depth=269.5\*122\*4\*60.5 mm)  
 Note: The size of the hole should be a little larger than recommended value that can accommodate all cables

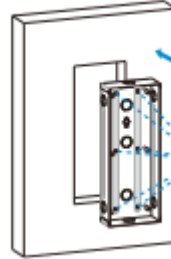

Insert the embedded box into the hole and make sure the cables of the device can route through the cable hole. Then mark the six holes of the wall embedded box on the wall

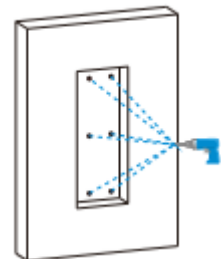

Take down the embedded box, then use a hand drill with 5mm diameter bit to make holes in the marked positions

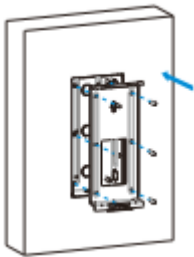

Use six M4x10 screws to fix the flash-mounting bracket on the embedded box

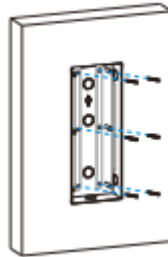

Place the embedded box into the square hole the edges of which align to the wall and make all cables go through the cable hole. Fix the embedded box with 6 TS4x20 screws. Then use cement or non-corrosive structural adhesives to fill the gap between the wall and embedded box

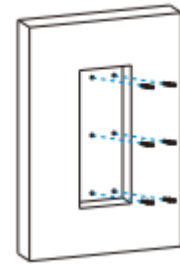

Insert the screw fixing seats into the hole you drill before

Without ST4x20 screw, please follow the below installation method.

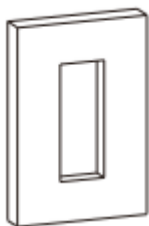

Dig out a square hole (height\*width\*depth=269.5\*122.4\*60.5mm) Note: The size of the hole should be a little bigger than recommended value that can accommodate all cables.

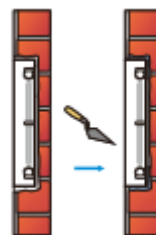

Use cement or non-corrosive structural adhesives to fill the gap between the wall and embedded box. Wait the adhesives material desiccation, go to the next step

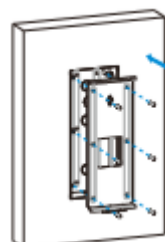

Use six M4X10 screws to fix the flash-mounting bracket on the embedded box.

**PCB INTERFACE**

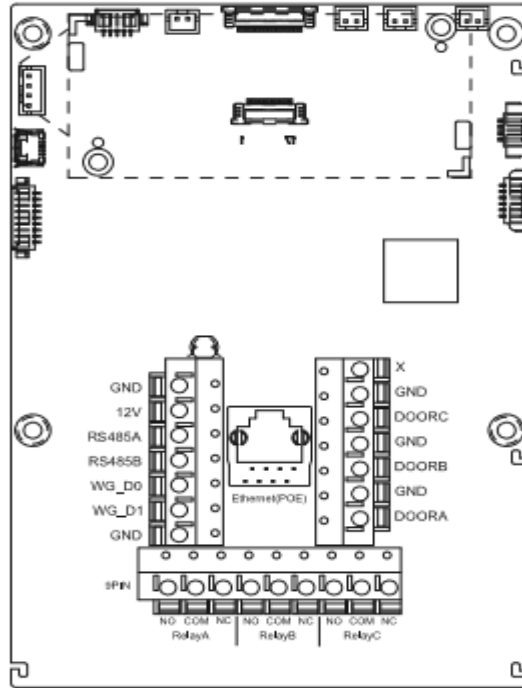

**APPLICATION SCENARIO**

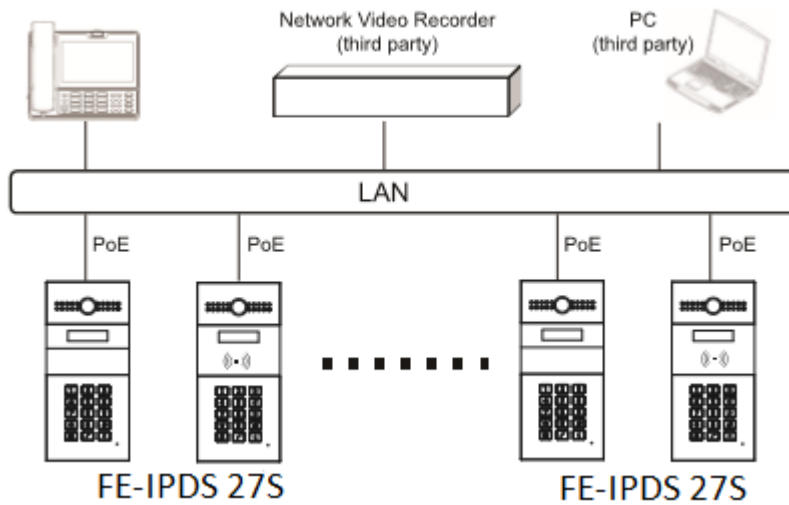

**CONFIGURATION**

1. IP Address Checking: Press \*2396# to enter the administrator setting interface. Click **System information** to get the IP address. 27S uses DHCP by default.
- 2.Account Registration:On web UI, go to the path:**Account -> Basic** page to register account and fill in the account information. (*Please refer to user manual for more information*).
- 3.DTMF Code Configuration:On web UI, go to the path: **Intercom -> Relay&Input ->Relay ID/DTMF** and choose the DTMF code number in corresponding area.

**OPERATION**

Make a call: Input the room number , press Dial key to make a call.

Receive a call: 27S supports Auto Answer by default. Incoming calls from indoor device will be answered automatically.

Unlock by DTMF: During the call, press the corresponding DTMF code in door phone to unlock 27S remotely.

Unlock by Private Key: When idle, enter # + 8 digital password + # to open the door.

Unlock by RF Card(Optional): Place the predefined RF Card in the RF reader area to open the door.

## Unpacking

Please make sure the package contains the following items:

### Universal Accessories:

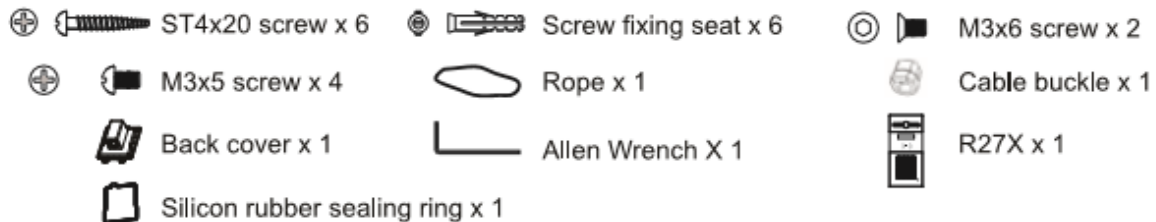

### Wall mounting Accessories:



### Flush mounting Accessories:

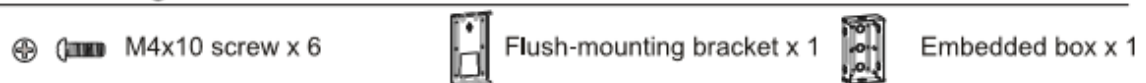

FREUND ELEKTRONIK A/S, IN COOPERATION WITH ITS SISTER COMPANY FREUND ELEKTRONIKA SARAJEVO, IS DEVELOPING IP-BASED INTERCOM, AUDIO, ACCESS CONTROL AND SMART HOME SOLUTIONS.

WE HAVE MORE THAN 30 YEARS OF EXPERIENCE IN THIS TECHNOLOGY FIELD AS DEVELOPER, MANUFACTURER AND RESALER COMPANY.

IN THE INDUSTRY, WE NEGOTIATE THE MOST INNOVATIVE SOLUTIONS WITHIN BUILDING COMMUNICATION. WE HAVE DAILY FOCUS ON DEVELOPMENT AND USER-FRIENDLINESS AND OUR PRODUCTS HAVE TECHNICAL HIGH QUALITY AND PLEASANT DESIGN.

AS A DEVELOPER AND MANUFACTURER OF OUR OWN IP-INTEGRA SYSTEMS, WE ARE ON TOP OF THE MOST ADVANCED SYSTEMS FOR DOOR TELEPHONY, PUBLIC AUDIO AND ACCESS CONTROL SOLUTIONS.

OUR DEVELOPMENT DEPARTMENT HAVE DEVELOPED, TOGETHER WITH OUR PARTNERS, ELEGANT AND ROBUST DOORPHONES, SIP-CENTRALS, TERMINALS, IP-SPEAKERS, ACCESS CONTROLLERS AND APPLICATIONS WITH INTELLIGENT FEATURES AND THE MOST ADVANCED TECHNOLOGY, BUT AT THE SAME TIME EASY FOR OUR CUSTOMERS TO USE.

FREUND GROUP IS ONE OF THE TOP PROVIDERS ON THE MARKET FOR IP-BASED BUILDING CONTROL AND COMMUNICATION AND RELATED SYSTEMS.

**FREUND ELEKTRONIKA d.o.o**

International Burch University | Francuske revolucije bb | 71210 Ilidza | Bosnia and Hercegovina

[www.ip-integra.ba](http://www.ip-integra.ba) | [info@ip-integra.com](mailto:info@ip-integra.com) | Tel. +387 33 922 890