



FE-IPDS-29S User Manual

Table of Content

- 1. Product Overview 3
 - 1.1 Product Description 3
 - 1.2 Connector Introduction..... 4
- 2. Daily Use 5
 - 2.1 Make a Call..... 5
 - 2.2 Receive a Call 6
 - 2.3 Unlock 7

1. Product Overview

1.1 Product Description

Freund FE-IPDS-29S is a SIP-compliant, hands-free, and video door phone. It can be connected with Freund indoor monitors for remote access controlling and monitoring. Users can communicate with visitors via audio and video calls and unlock the door if they need. Users can also use RFID cards to unlock the door. It is applicable in apartments, offices and so on.

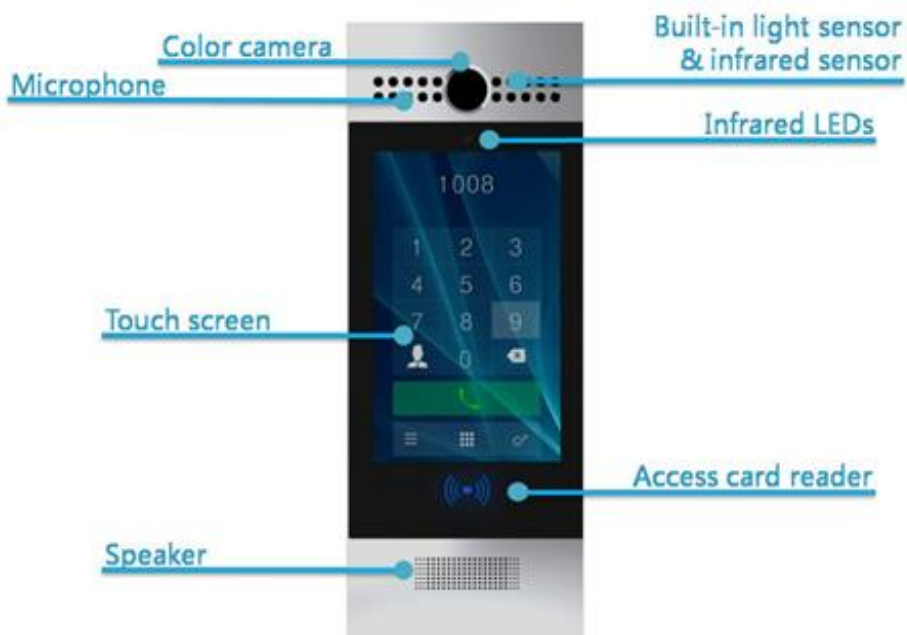

PRODUCT DESCRIPTION

1.2 Connector Introduction

Ethernet (POE): Ethernet (POE) connector which it can provide both power and network connection.

12V/GND: External power supply terminal if POE connector is not available.

RS485A/B: RS485 Terminal

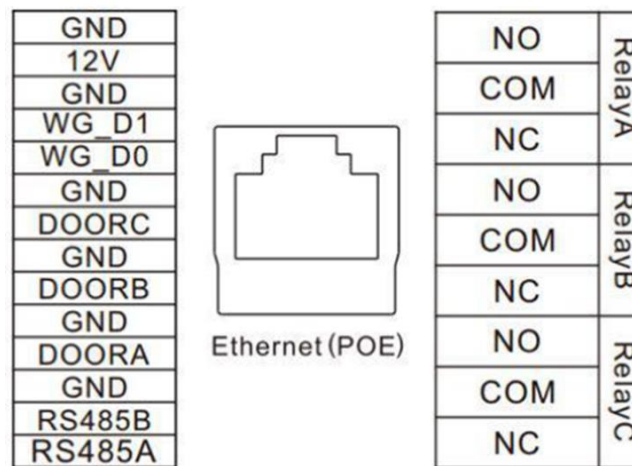

CONNECTOR INTRODUCTION

Connector	Description
Ethernet (POE)	Ethernet (POE) connector which can provide both power and network connection.
12V/GND	External power supply terminal if POE is not available.
WG_D0/1	Wiegand terminal for Wiegand access control
RS485A/B	RS485 terminal for automation system control (i.e., Elevator control).
DOOR A/B/C	Trigger signal input terminal (i.e., Press indoor button to open relay).
Relay A/B/C	NO/NC Relay control terminal.

2. Daily Use

2.1 Make a Call

Call: When approaching the intercom unit, when motion is detected, the intercom will wake up from screensaver. On display, a contact list is shown. Users can scroll up and down to locate a contact. Call can be placed by tapping on the Call icon next to the found contact.

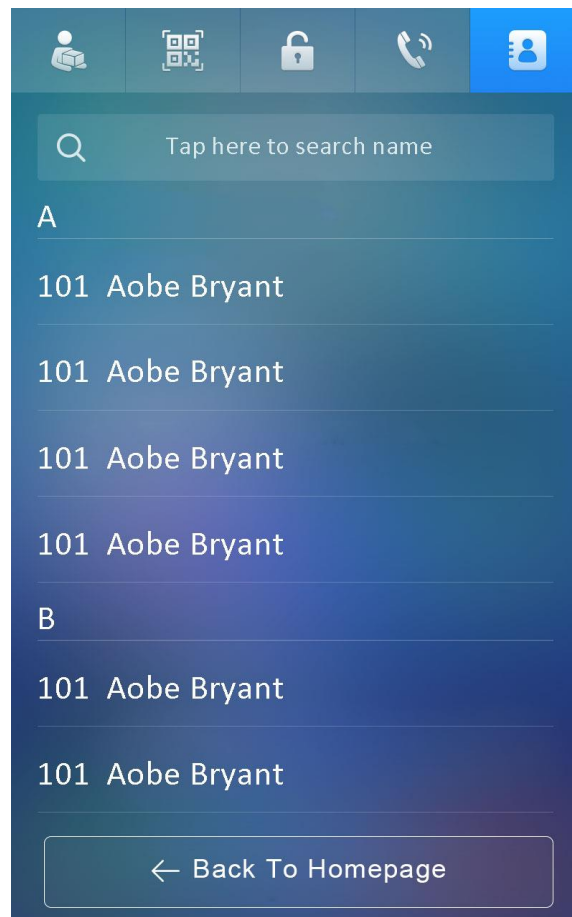

2.2 Receive a Call

FE-IPDS-29S will auto answer the incoming calls by default. If Auto Answer is disabled, users can press “**Dial Key**” to answer the incoming calls.

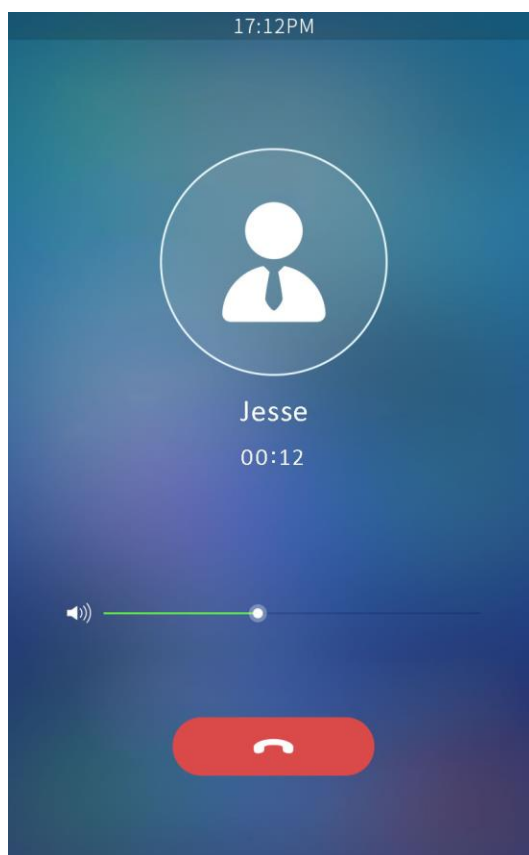

2.3 Unlock

Unlock using private PIN codes

Users can unlock doors by using private pin code. To do this, users must press the Padlock icon on the screen and will be greeted by numeric keypad. After entering a PIN code, users must press the Unlock button. The screen will show either “Door opened successfully”, or “Invalid password”, depending on whether the correct PIN code was entered.

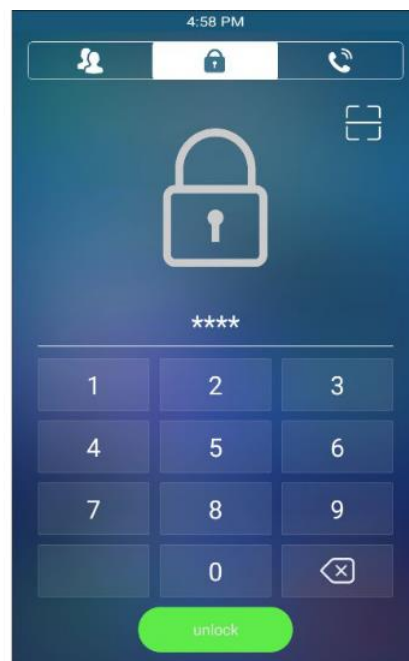
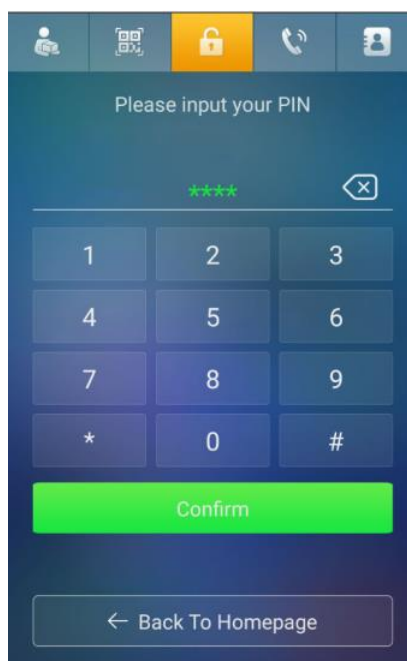

Unlock using RFID Cards

Place the predefined user cards in RFID card reader to unlock. Under normal conditions, FE-IPDS-29S will announce “The door is now opened.” If the card has not been registered, FE-IPDS-29S will show “Unauthorized.” Both 13.56MHz and 125KHz RFID cards are supported on FE-IPDS-29S.

Unlock by DTMF codes

During a call, the tenant can unlock a door for a visitor by either pressing the Unlock button on the indoor monitor, pressing the padlock key in the IP-INTEGRA VoIP app, or pressing the pre-determined DTMF code on the IP-INTEGRA VoIP app keypad (default number “8”).

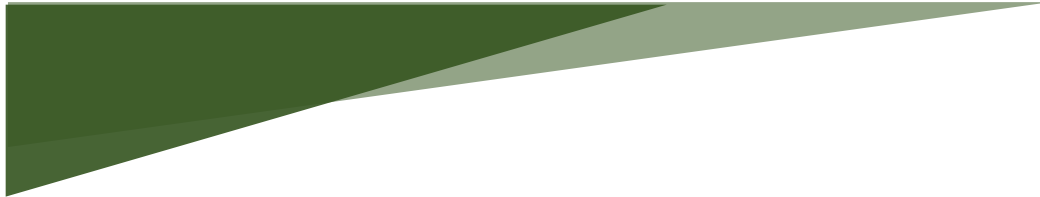

Freund Elektronik A/S, in cooperation with our sister company Freund Elektronika D.O.O. Sarajevo, is developing an IP-Based Intercoms, Audio Systems, Access Control and Smart Home solutions.

As a developer, manufacturer, and reseller, we have been self-improving and perfecting ourselves for over 30 years.

In the industry, we negotiate the most advanced and innovative solutions regarding the building communication. Our daily focus is on the development and user friendliness of our high quality and pleasantly designed products.

As a developer and manufacturer of our own IP-INTEGRA system, we have made a top-of-the-line products for Door Telephony, Public Audio, and Access Control solution.

Our development department, together with our partners, has created elegant and robust door phones, SIP-Centrals, Terminals, IP-Speakers, ACC Controllers, and applications with intelligent features using the most advanced technologies when available, and creating new technologies when they are not while keeping it simple for our customers.

